

**Site  
Entrance**

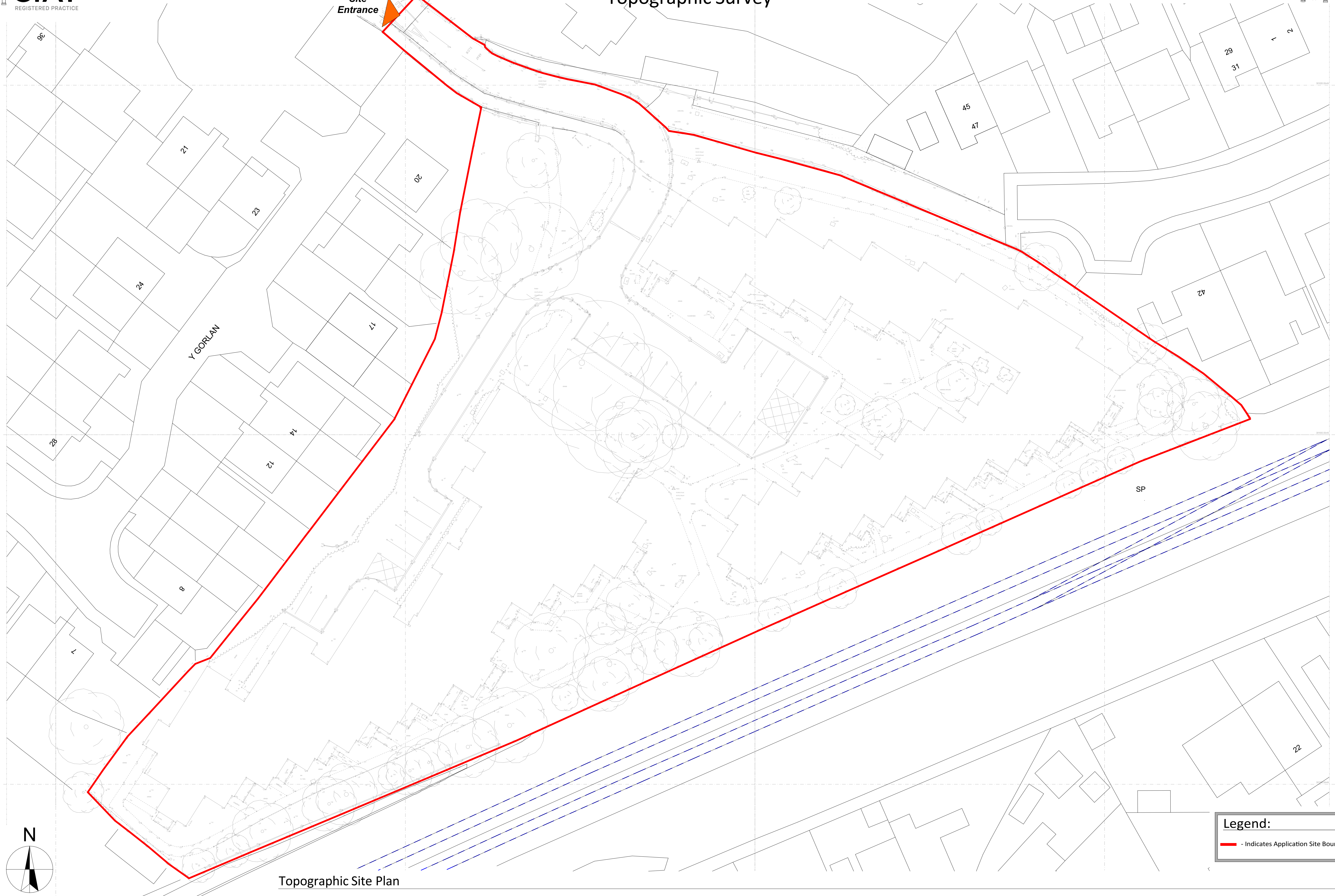

## Topographic Site Plan

:250

<b>Revision:</b>	<b>Date:</b>	<b>By:</b>
A - Boundary/red line update	3rd Dec 2025	RH
B - Minor updates for PAC	29th Jan 2026	RH

Notes:



**Client:**  
Tai Wales & West Housing

Scale: Noted  
Date: Jan '26  
Drawn: RH

**Job Title:**  
Proposed Residential Development, Maes Emlyn, Rhyl,  
Denbighshire LL18 4AB

Drawing Title:  
00 SERIES DRAWINGS -  
Topographic Site Plan

R622 - 102B